

Product Dimensions

Large Capacity Vented Dryers

Flat Controls

T1312

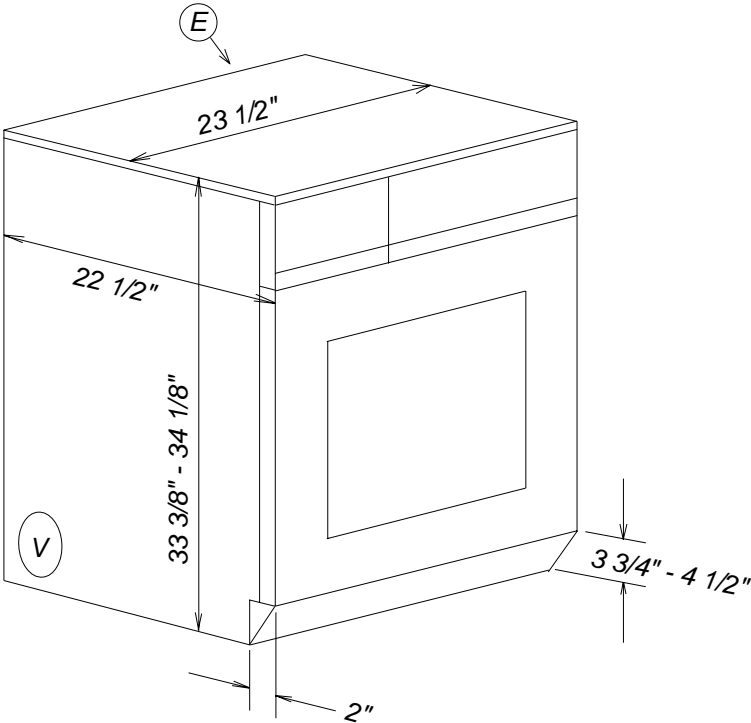

Location Codes	
E -	5 foot - 208-240 Volt - 15 Amp 4-wire (2 live / neutral / ground) molded plug power supply connects upper right rear (NEMA 14-30 Configuration).
V-	Venting location may be adjusted to lower right or left side or lower left rear (see separate sheet).
Notes	
<ul style="list-style-type: none">• All installations must be done in accordance with local codes• See "Cut-out Dimensions" sheet for undercounter or built-in space requirements• Optional Easy Installation Kits utilize existing 208-240 Volt - 30 Amp line to connect two Miele machines without rewiring .	

Product Dimensions

Large Capacity Vented Dryer

Angled control

T1313

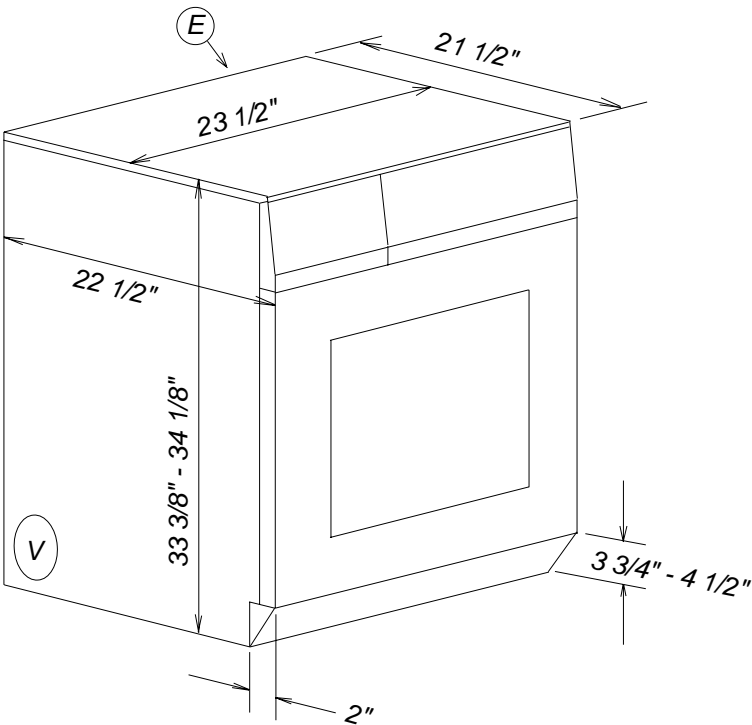

Location Codes	
E -	5 foot - 208-240 Volt - 15 Amp 4-wire (2 live / neutral / ground) molded plug power supply connects upper right rear (NEMA 14-30 Configuration).
V-	Venting location may be adjusted to lower right or left side or lower left rear (see separate sheet).
Notes	
<ul style="list-style-type: none">• All installations must be done in accordance with local codes• See "Cut-out Dimensions" sheet for undercounter or built-in space requirements• Optional Easy Installation Kits utilize existing 208-240 Volt - 30 Amp line to connect two Miele machines without rewiring.	

Product Dimensions

Large Capacity Condenser Dryers

Flat Controls

T1332C

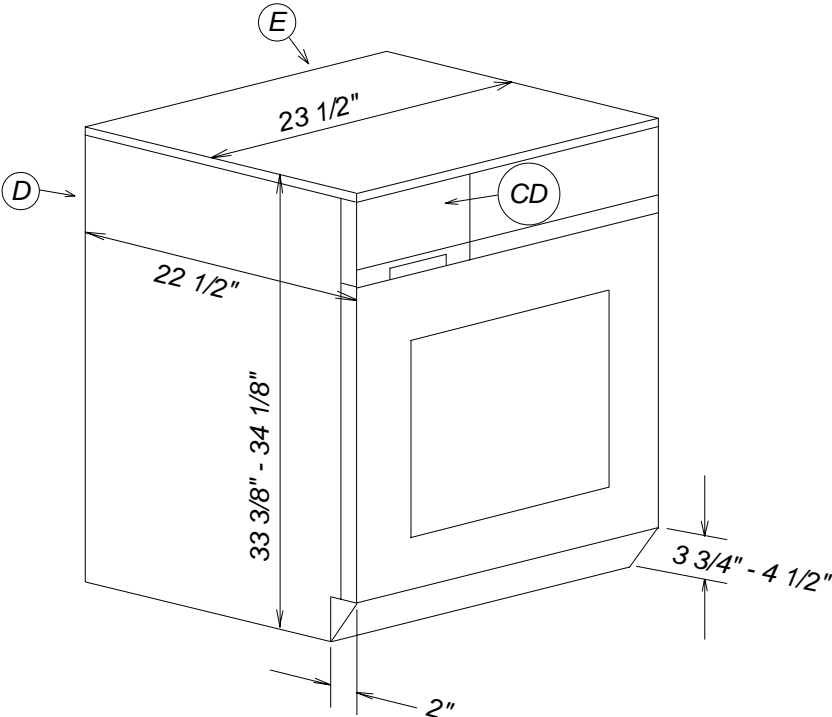

Location Codes	
E -	5 foot - 208-240 Volt - 15 Amp 4-wire (2 live / neutral / ground) molded plug power supply connects upper right rear (NEMA 14-30 Configuration).
D -	Drain location
CD -	Removable drawer if drain connection is not utilized
Notes	
<ul style="list-style-type: none">• All installations must be done in accordance with local codes• See "Cut-out Dimensions" sheet for undercounter or built-in space requirements• Optional Easy Installation Kits utilize existing 208-240 Volt - 30 Amp line to connect two Miele machines without rewiring.	

Product Dimensions

Large Capacity Condenser Dryer

Angled control

T1333C

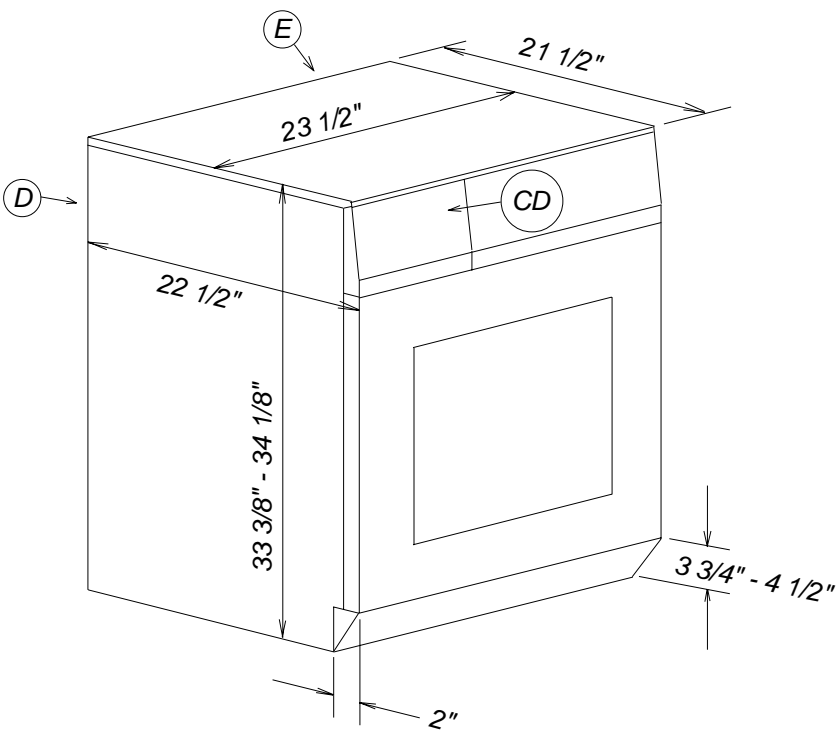

Location Codes
<p>E - 5 foot - 208-240 Volt - 15 Amp 4-wire (2 live / neutral / ground) molded plug power supply connects upper right rear (NEMA 14-30 Configuration).</p> <p>D - Drain location</p> <p>CD - Removable drawer if drain connection is not utilized</p>
Notes
<ul style="list-style-type: none">• All installations must be done in accordance with local codes• See "Cut-out Dimensions" sheet for undercounter or built-in space requirements• Optional Easy Installation Kits utilize existing 208-240 Volt - 30 Amp line to connect two Miele machines without rewiring.

Product Dimensions

Large Capacity Condenser Dryers

Flat Controls - Decor unit

T1339C

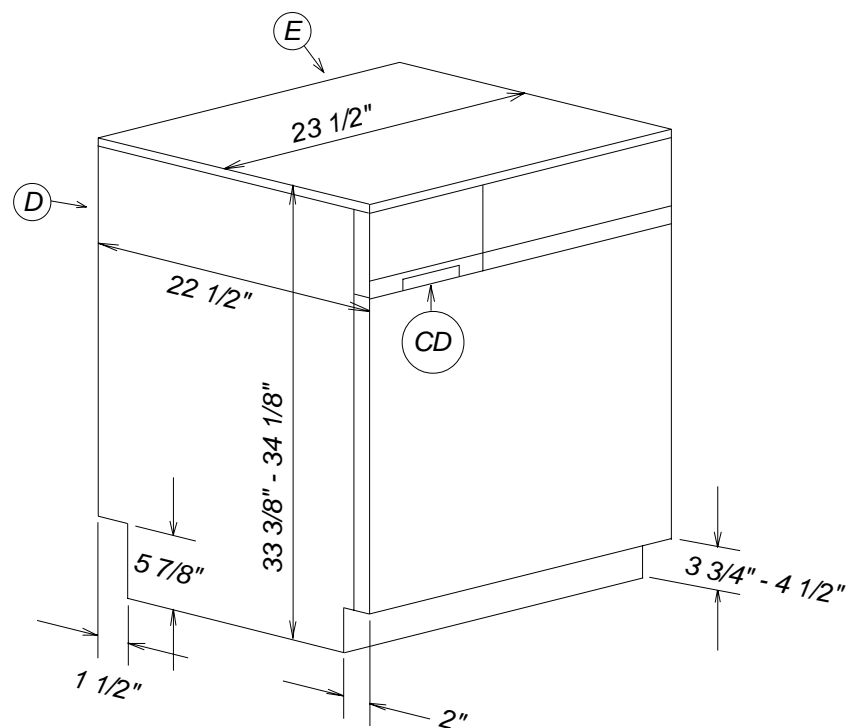

Location Codes	
E -	5 foot - 208-240 Volt - 15 Amp 4-wire (2 live / neutral / ground) molded plug power supply connects upper right rear (NEMA 14-30 Configuration).
D -	Drain location
CD -	Removable drawer if drain connection is not utilized
Notes	
<ul style="list-style-type: none">• All installations must be done in accordance with local codes• See "Cut-out Dimensions" sheet for undercounter or built-in space requirements• Optional Easy Installation Kits utilize existing 208-240 Volt - 30 Amp line to connect two Miele machines without rewiring.	

Cut-out Dimensions

Built-in Installations

Large Capacity Laundry Products

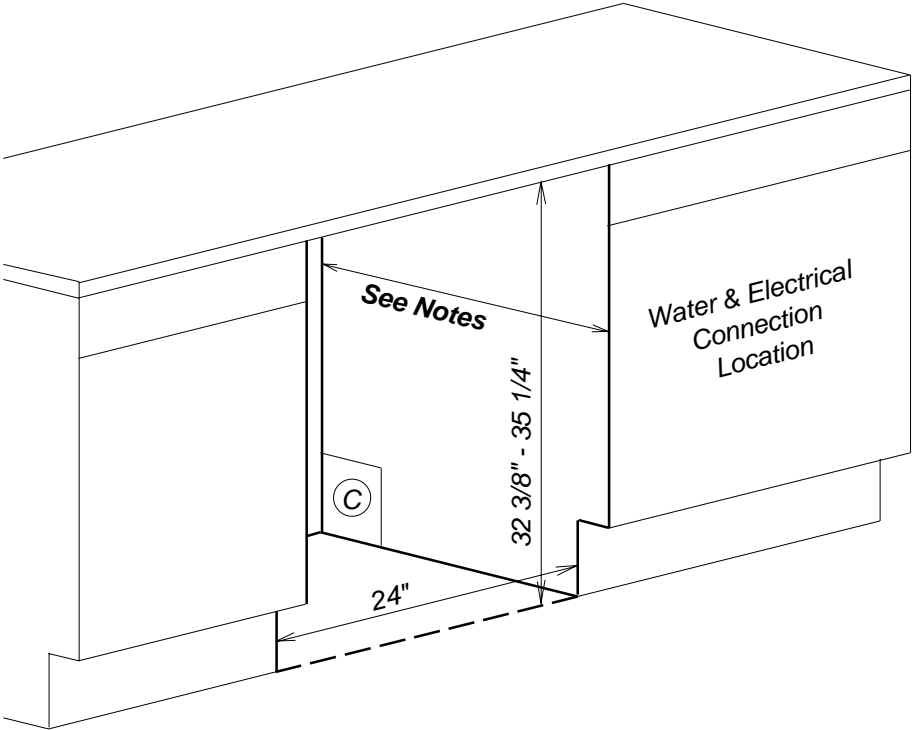

Location Codes
C - Cutout for Electric and Vent or Drain pass-through. Adjust according to duct or drain location.

Notes
<ul style="list-style-type: none">• Needed depth will vary by model number: T1302, T1303, T1322C, T1323C: 24" minimum T1329C: 25" minimum• Typically requires removal of unit's lid. Out of box unit height dimension without lid is 32 5/16" - 32 11/16".

NOTE: Drawing is not to scale.
SPECIFICATION SHEETS 010706

Product Dimensions

Easy Installation Kits

057B / 060B

Miele

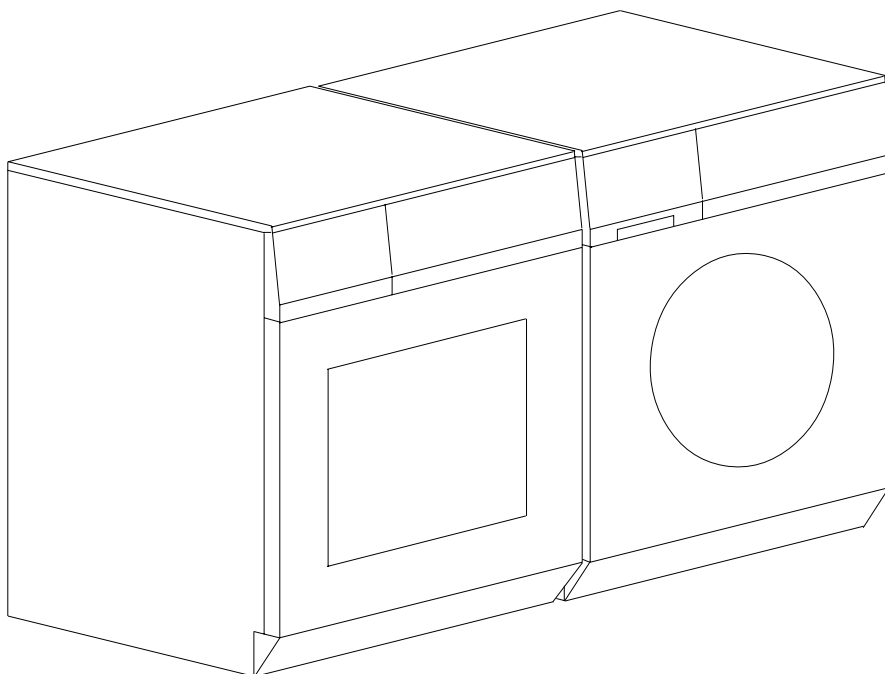
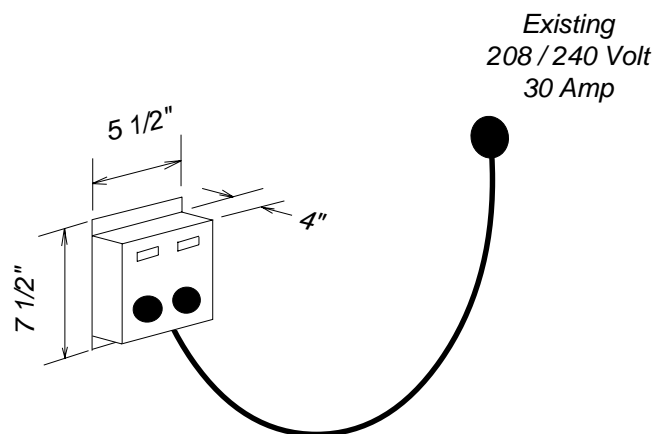

Notes

- **Connect Washer and Dryer to Easy Installation Kit**
- **All installations must be done in accordance with local codes**
- **057B Kit fitted with a NEMA10-30 Plug**
- **060B Kit fitted with a NEMA14-30 Plug**

NOTE: Drawing is not to scale.
SPECIFICATION SHEETS 010706

Product Dimensions

Laundry Stand

WTS420 - White Only

Miele

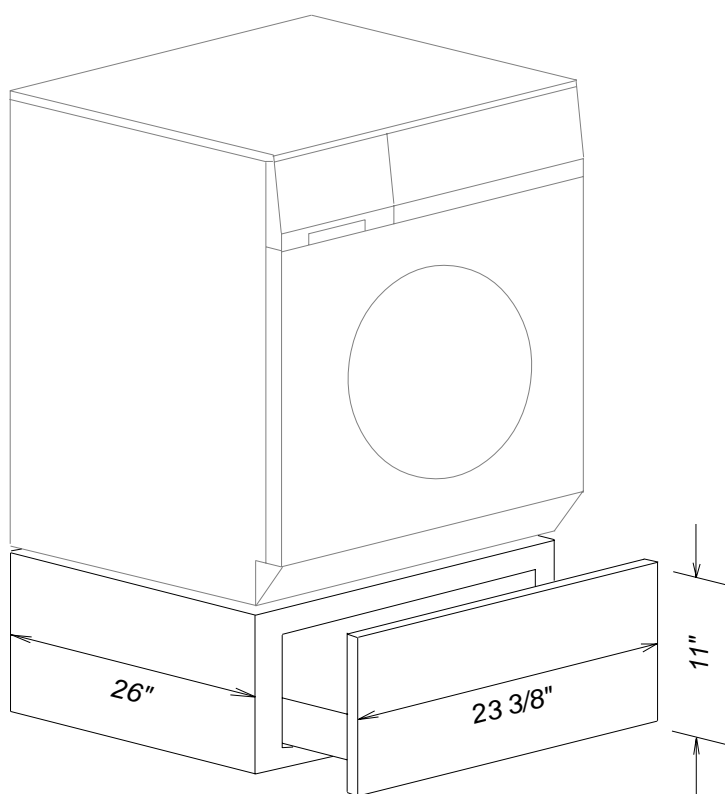

Notes

- *For use with both large and super capacity washers or tumble dryers.*
- *All installations must be done in accordance with local codes*

NOTE: Drawing is not to scale.
SPECIFICATION SHEETS 010706

Product Dimensions

Stacked Washer & Dryer

Example Combination

W1113 + T1313

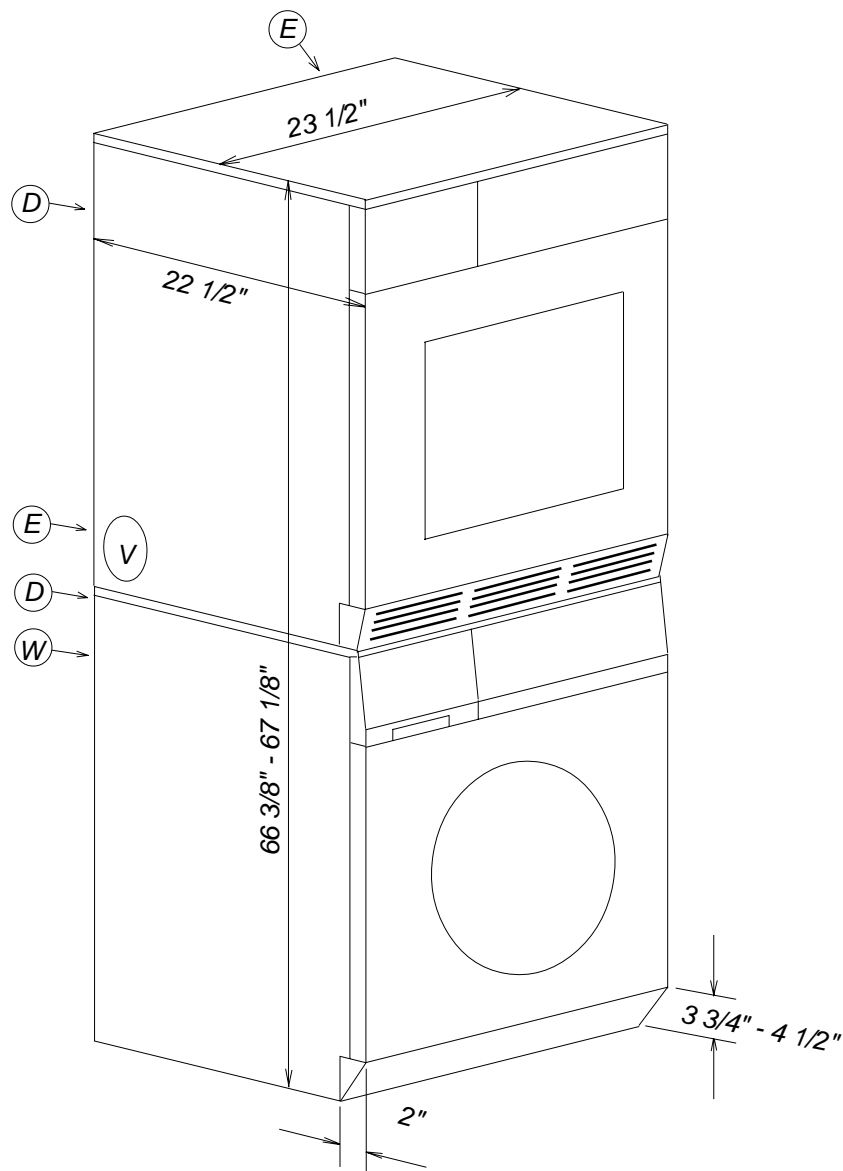

Location Codes
D - 5 foot flexible drain hose connects upper left rear.
E - 208-240 Volt - 15 Amp 5 foot 4-wire (2 live / neutral / ground) molded plug power supply connects upper right rear.
W - 5 foot separate flexible hot and cold water intake hoses connect upper left rear.
V- Venting location may be adjusted to lower right or left side or lower left rear (see separate sheet).

Notes
<ul style="list-style-type: none">• All installations must be done in accordance with local codes• See "Cut-out Dimensions" sheet for undercounter or built-in space requirements• Optional Easy Installation Kits utilize existing 208-240 Volt - 30 Amp line to connect two Miele machines without rewiring.• Remove transport struts in rear of washing machine before installation.

NOTE: Drawing is not to scale.
SPECIFICATION SHEETS 010706

Panel Information

Integrated Laundry

T1339C Decor Unit



These units come equipped with a full size white front panel. These units are also designed to either accept a thin insert or a custom front panel supplied by the custom cabinet maker.

Sizes are as follows:

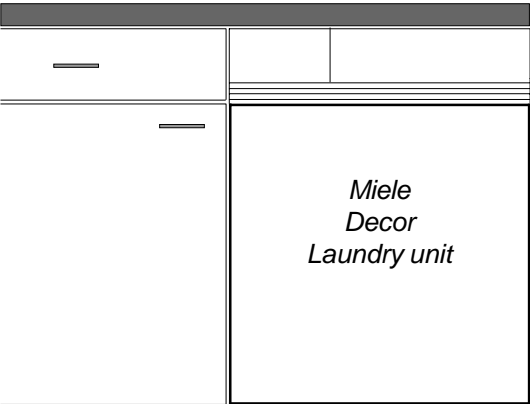

Version 1 - Thin insert

Width: 23 1/4" for all machines
Thickness: up to 1/8"
Height: 25" in all cases

With this version, a thin white frame will be exposed after installation

Version 2 - Custom Front Panel

Width: 23 3/8" for all machines
Thickness: up to 3/4"
Height: Up to 25"

With this version, the existing front panel is removed and replaced by the new custom panel

Hinge Notches

In certain installations, notches will be required to accomodate the hinges in the front panel.

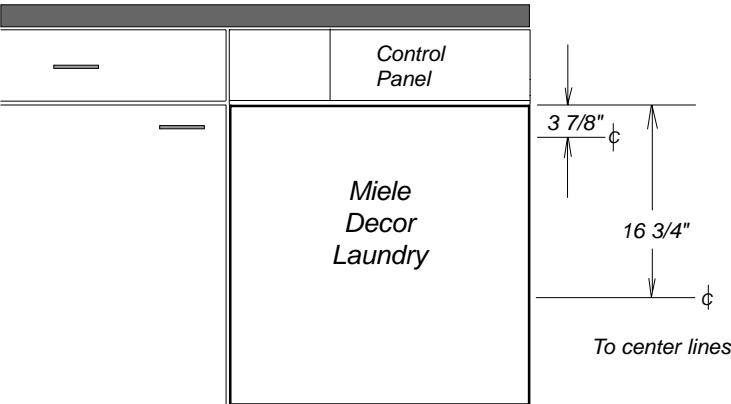

Note: To insure access to customer servicable features, a minimum 4" toe kick above finished floor (AFF) is required.

Notch Pattern

For this installation, drill the following pattern in the appropriate locations.

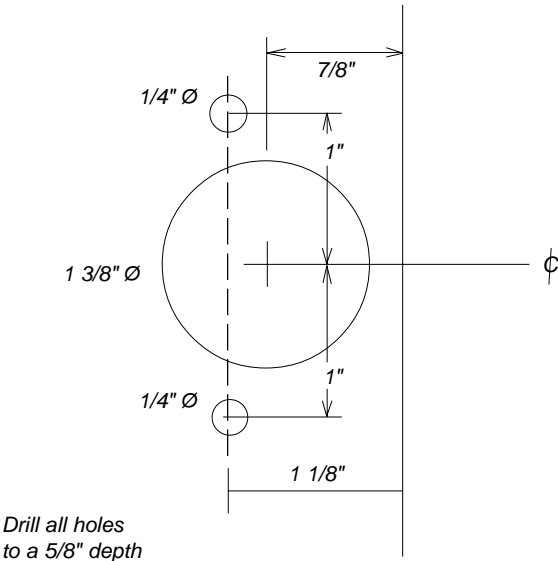

Vent Locations

Vented dryers

T1312, T1313



Vent Locations		
Left Side View	Rear View	Right Side View
Corresponding Dryer Height with NO lid: 32 1/8" - 32 7/8"		
Corresponding Dryer Height with lid: 33 3/8" - 34 1/8"		

Vent Duct Calculations			
Maximum Duct Lengths	Type of Bend or duct	Effective Radius	Subtract
4" diameter	Flexible duct 90°	4 - 12 inches	1 3/4 feet
4 3/16" diameter	Flexible duct 90°	12 - 20 inches	1 1/4 feet
4 3/4" diameter	Flexible duct 45°	4 - 20 inches	1 1/4 feet
5" diameter	Smooth duct 90° or 45°	4 - 8 inches	1 1/4 feet
	Elbow 90°	Sharp bend	8 1/4 feet
	Concertina bend	8 inch	2 3/4 feet
	Segmented bend	8 inch	2 feet
	Louvered wall or window vent (#03780400)		12 1/2 feet
	Wall vent kit with flap (#00087184)		5 feet
	Window vent kit with flap (#00087185)		5 feet
	Exhaust connection - left		20 feet
	Exhaust connection - right		33 feet
	Flat duct (#01221330)		59 feet

DO NOT use vinyl ducting with Miele appliances.

Vent Locations

Stacked Washer & Dryer

Example Combination

