

PRODUCT MODEL NUMBERS

GHW9400P
GHW9460P

Electrical: 120-volt, 60 Hz, AC-only,
15 or 20 amp electrical supply. A time-delay fuse
or circuit breaker and separate circuit is
recommended.

OVERALL DIMENSIONS

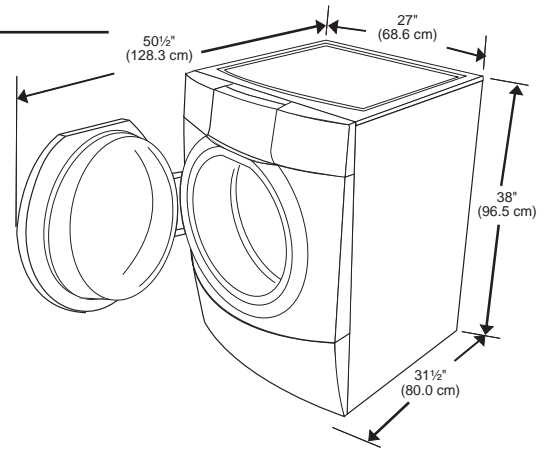

RECESSED AREA AND CLOSET INSTALLATIONS

For closet installation, with a door, the minimum ventilation
openings in the top and bottom of the door are required (view 2).
Louvered doors with equivalent air ventilation openings in the top
and bottom are acceptable.

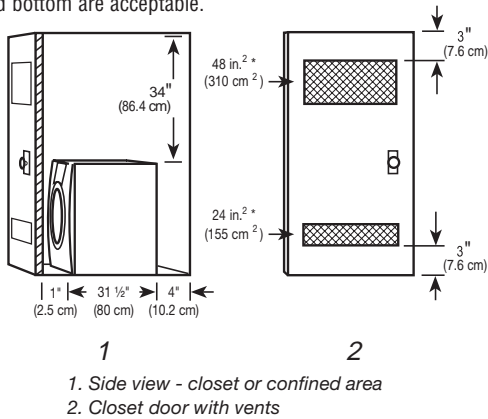

Washer on Pedestal

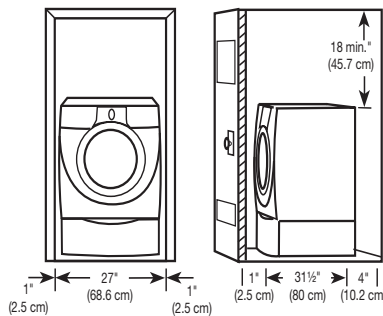

Recommended installation spacing for cabinet installation

For cabinet installation, with a door, the minimum
ventilation openings in the top are required.

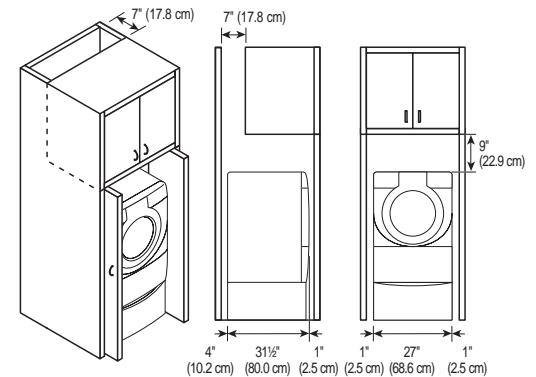

UNDERCOUNTER INSTALLATION

Dimensions shown are for minimum spacing.

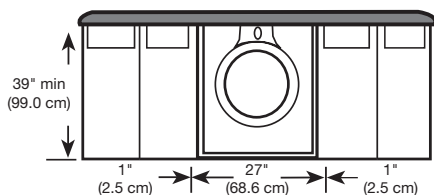

Stacked Washer and Dryer

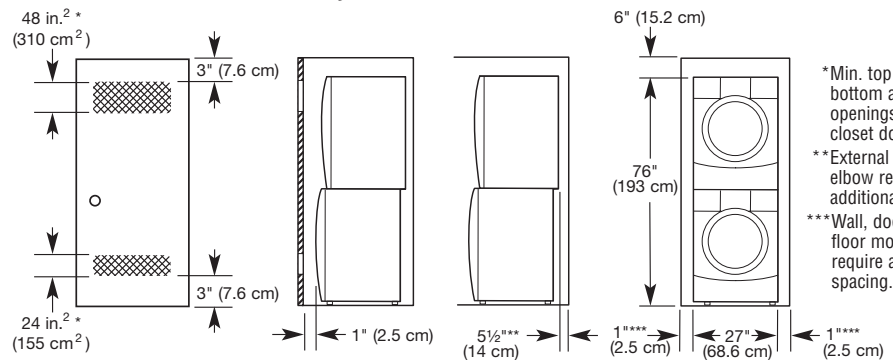

DRAIN SYSTEM OPTIONS

Standpipe drain system - wall or floor (view 1 & 2)

The standpipe drain requires a minimum diameter standpipe of 2 in. (5 cm). The
minimum carry-away capacity can be no less than 17 gal. (64 L) per minute.
The top of the standpipe must be at least 30 in. (76.2 cm) high and no higher
than 96 in. (2.4 m) from the bottom of
the washer.

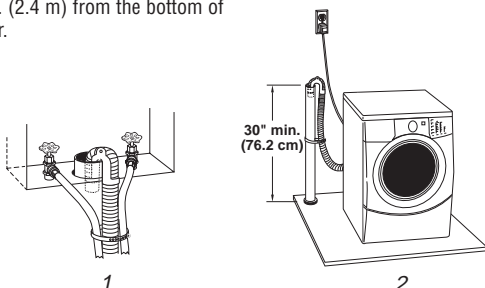

Laundry tub drain system (view 1)

The laundry tub needs a minimum
20 gal. (76 L) capacity. The top of
the laundry tub must be at least
30 in. (76.2 cm) above the floor.

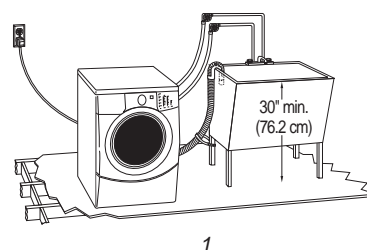

Floor drain system (view 2)

The floor drain system requires a siphon break
that may be purchased separately.
The siphon break must be a minimum of 28 in.
(71 cm) from the bottom of the washer.
Additional hoses might be needed.

