

WWD30



FEATURES

- Temperature range of 80°F to 200°F

- 30" wide, it's spacious enough for an entrée and several sides

- Matches Wolf ovens and ranges, or accepts custom panel

- Hidden electronic controls

- Automatic shut-off

- Rigorously tested in our U.S. manufacturing facilities for decades of use

- Exceptional 24/7 support from our Customer Care team in Madison

- UL approved for warming towels

- Four preset temperatures make it easy to warm favorite foods

- Fan assist for even heat distribution that keeps juicy foods juicy, crisp foods crisp

- Removable rack lets you double-stack items

- Full-extension drawer for easy access to foods

- Removable stainless steel drawer pan for easy clean-up

ACCESSORIES

- 30" Stainless Professional Front Panel - 2" Thick

- 36" Stainless Professional Front Panel - 2" Thick

- 6-Piece Container Set

- Warming Drawer Front Panel - Integrated

- Warming Drawer Front Panel - L Series

- Warming Drawer Front Panels - M Series

- Warming Drawer Front Panels - E Series

- Stainless Steel Tubular, Pro and Black Tubular Handles

- Warming Drawer Front Panels

- Accessories available through an authorized dealer.
For local dealer information, visit subzero-wolf.com/locator.



FRONT PANEL OPTIONS



30" E SERIES TRANSITIONAL



30" E SERIES PROFESSIONAL



30" E SERIES CONTEMPORARY



30" M SERIES CONTEMPORARY



30" M SERIES TRANSITIONAL



30" M SERIES CONTEMPORARY STAINLESS



30" M SERIES PROFESSIONAL



30" L SERIES



30" INTEGRATED

PRODUCT SPECIFICATIONS

| | |
|--------------------|--------------------------------|
| Model | WWD30 |
| Dimensions | 29 7/8"W x 10 3/8"H x 22 3/4"D |
| Capacity | 1.6 cu. ft. |
| Weight | 100 lbs |
| Electrical Supply | 120 VAC, 60 Hz |
| Electrical Service | 15 amp dedicated circuit |
| Power Cord Length | 3 Feet |
| Receptacle | 3-prong grounding-type |

ELECTRICAL

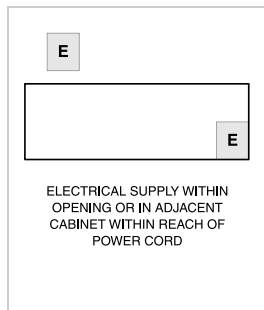

INSTALLATION WITH FRONT PANEL Accessory front panels may affect overall product dimensions and opening dimensions. Refer to [Reveal](http://subzero-wolf.com/reveal) for more information: subzero-wolf.com/reveal

NOTE: Dimensions in parenthesis are in millimeters unless otherwise specified

DIMENSIONS

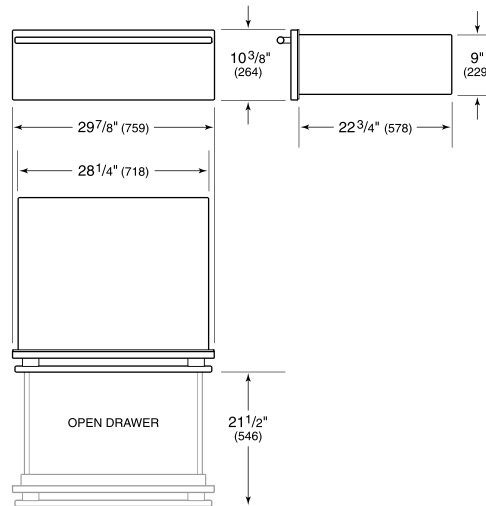

FLUSH INSTALLATION

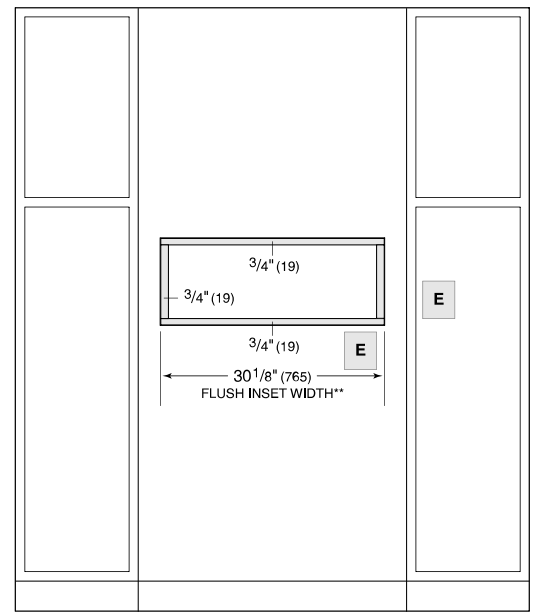
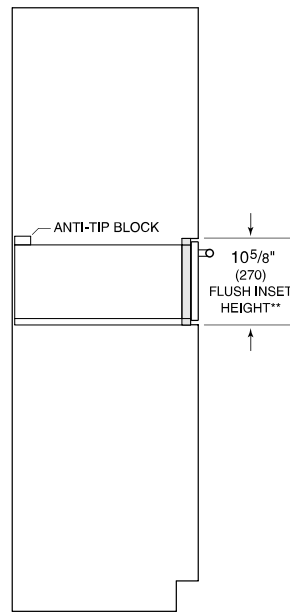
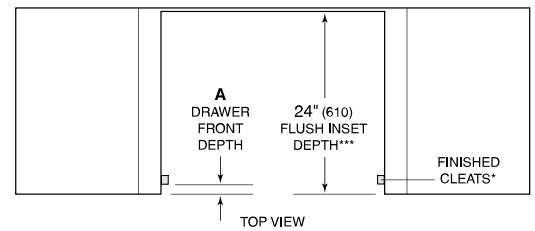

SIDE VIEW

FRONT VIEW

*Will be visible and should be finished to match cabinetry.

**Dimension provides minimum reveals.

***24 1/8" (613) for E series contemporary drawer front.

NOTE: Location of electrical supply within opening may require additional cabinet depth.