

WWD300



FEATURES

- Temperature range of 80°F to 200°F
- 30" wide, it's spacious enough for an entrée and several sides
- Matches Wolf ovens and ranges, or accepts custom panel
- Hidden electronic controls
- Automatic shut-off
- Rigorously tested in our U.S. manufacturing facilities for decades of use
- Exceptional 24/7 support from our Customer Care team in Madison
- UL approved for warming towels
- Four preset temperatures make it easy to warm favorite foods
- Fan assist for even heat distribution that keeps juicy foods juicy, crisp foods crisp
- Removable rack lets you double-stack items
- Full-extension drawer for easy access to foods
- Removable stainless steel drawer pan for easy clean-up

ACCESSORIES

- 30" Stainless Professional Front Panel - 2" Thick
- 36" Stainless Professional Front Panel - 2" Thick
- 6-Piece Container Set
- Warming Drawer Front Panel - Integrated
- Warming Drawer Front Panels - M Series
- Warming Drawer Front Panels - E Series

Accessories available through an authorized dealer.
For local dealer information, visit subzero-wolf.com/locator.



PRODUCT SPECIFICATIONS

Model	WWD300
Dimensions	29 7/8"W x 10 3/8"H x 22 3/4"D
Capacity	1.6 cu. ft.
Weight	100 lbs
Electrical Supply	120 VAC, 60 Hz
Electrical Service	15 amp dedicated circuit
Power Cord Length	3 Feet
Receptacle	3-prong grounding-type

ELECTRICAL

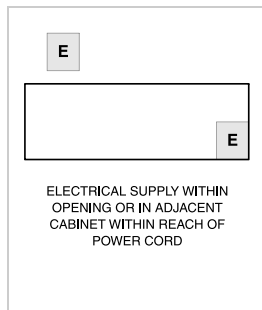

INSTALLATION WITH FRONT PANEL Accessory front panels may affect overall product dimensions and opening dimensions. Refer to [Reveal](http://subzero-wolf.com/reveal) for more information: subzero-wolf.com/reveal

NOTE: Dimensions in parenthesis are in millimeters unless otherwise specified

DIMENSIONS

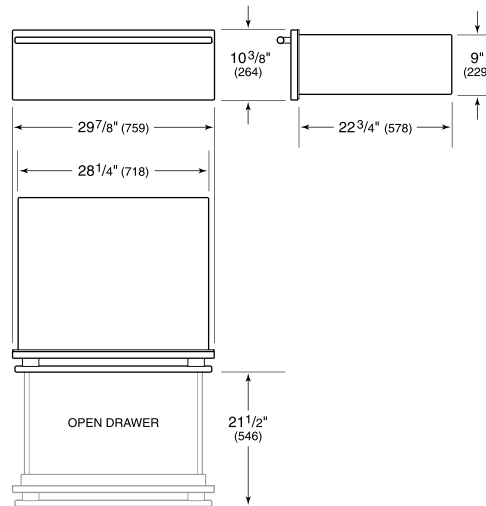

FLUSH INSTALLATION

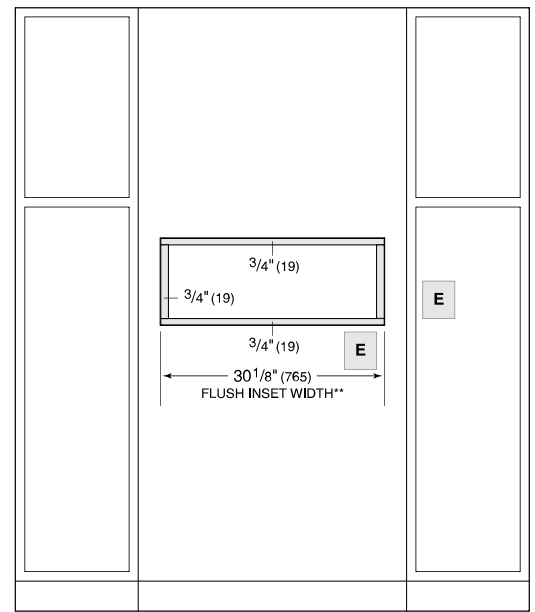
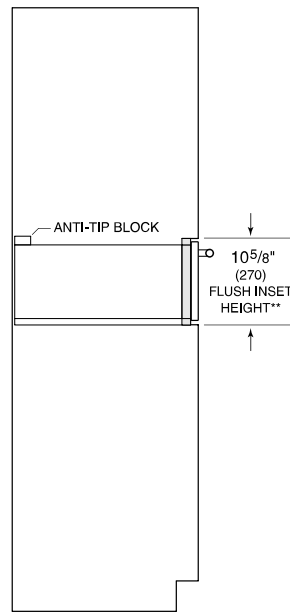
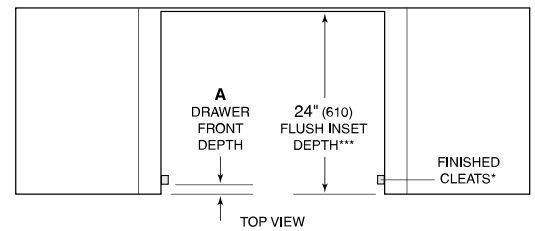

SIDE VIEW

FRONT VIEW

*Will be visible and should be finished to match cabinetry.

**Dimension provides minimum reveals.

***24 1/8" (613) for E series contemporary drawer front.

NOTE: Location of electrical supply within opening may require additional cabinet depth.