

IT-36CI



**FEATURES**

- Monitor and control remotely with Wi-Fi connectivity

---

- Accepts custom panels for an integrated look within cabinetry or stainless-steel accessory panels and handles to match other Sub-Zero, Wolf, and Cove products

---

- Preserves frozen foods with frigid, dry air

---

- Controls temperature within one degree of setpoint

---

- Locks in cold air with a magnetic door seal system

---

- Fight spoilage and odors with a NASA-inspired air purification system

---

- Filters water and ice, removing contaminants, chlorine taste, and odor

---

- Yields ice automatically and "max ice" for additional production

---

- Keeps produce fresher with high-humidity, sealed crisper and deli drawers

---

- Refer to freshness cards for tips on food preservation, use, and care

---

- Promotes easy clean-up with Nano-coated, spill-proof shelves

---

- Control brightness with soft-on LED lighting

**ACCESSORIES**

- Air Purification Cartridge

---

- Egg Container

---

- Reduced Toekick Divider

---

- Stainless Steel Side Panel

---

- Stainless Steel Top Panel

---

- Water Filter

---

- Stainless Steel Tubular Handles

---

- Stainless Steel Pro Handles

---

- Dual Installation Kits

---

- Stainless Steel Door Panels With Pro Handle

---

- Stainless Steel Door Panels With Tubular Handle

---

- Stainless Steel Drawer Panels With Pro Handles

---

- Stainless Steel Drawer Panels With Tubular Handles

---

- Stainless Steel Dual Installation Kickplates

Accessories are available through an authorized dealer. For local dealer information, visit [subzero-wolf.com/locator](http://subzero-wolf.com/locator).



**HANDLE ACCESSORIES**

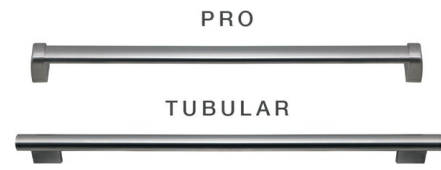

**PRODUCT DETAILS**

**REFRIGERATOR**

- LED refrigerator and freezer lights
- 4 glass refrigerator shelves (3 adjustable; 1 stationary)
- Crisper drawer with dividers and sliding cover
- 3 door bins (2 adjustable; 1 stationary)
- 1 adjustable dairy compartment

**FREEZER**

- 2 full-extension roll-out freezer drawers; one with adjustable dividers
- Automatic ice maker with removable ice container

**PRODUCT SPECIFICATIONS**

Model	IT-36CI
Dimensions	36"W x 84"H x 24"D
Door Clearance	34 1/2"
Drawer Clearance	18 3/8"
Weight	460 lbs
Refrigerator Capacity	13.3 cu. ft.
Freezer Capacity	6.4 cu. ft.
Electrical Supply	115 VAC, 60 Hz
Electrical Service	15 amp dedicated circuit

**ELECTRICAL**

**PLUMBING**

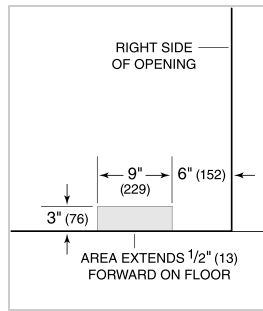
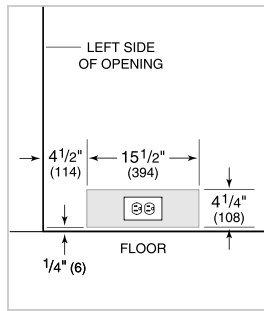

**PANEL SPECIFICATIONS** For complete panels specifications including width/height, weight requirements and thickness requirements visit [subzero-wolf.com/reveal](http://subzero-wolf.com/reveal).

**NOTE:** Dimensions in parenthesis are in millimeters unless otherwise specified

**INTERIOR VIEW**

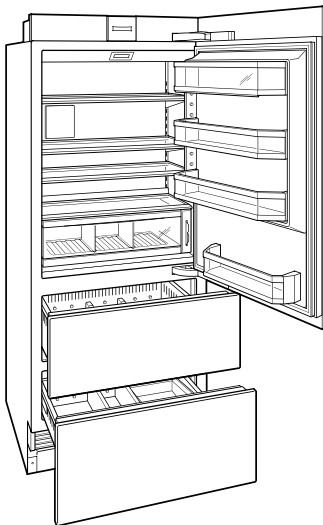

This illustration is intended for interior reference only and may not represent the exterior of the model being specified.

**DIMENSIONS**

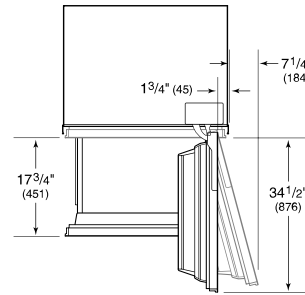
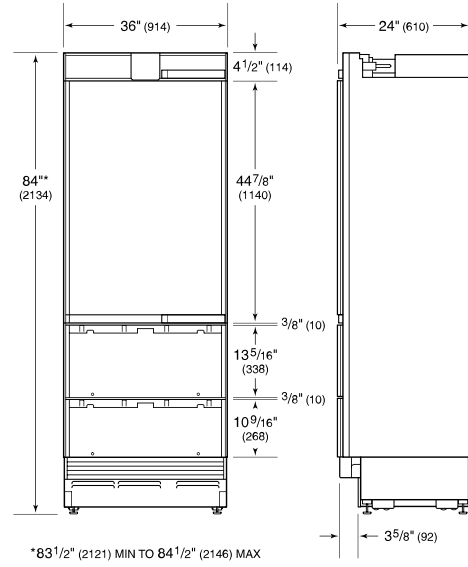

**STANDARD INSTALLATION**

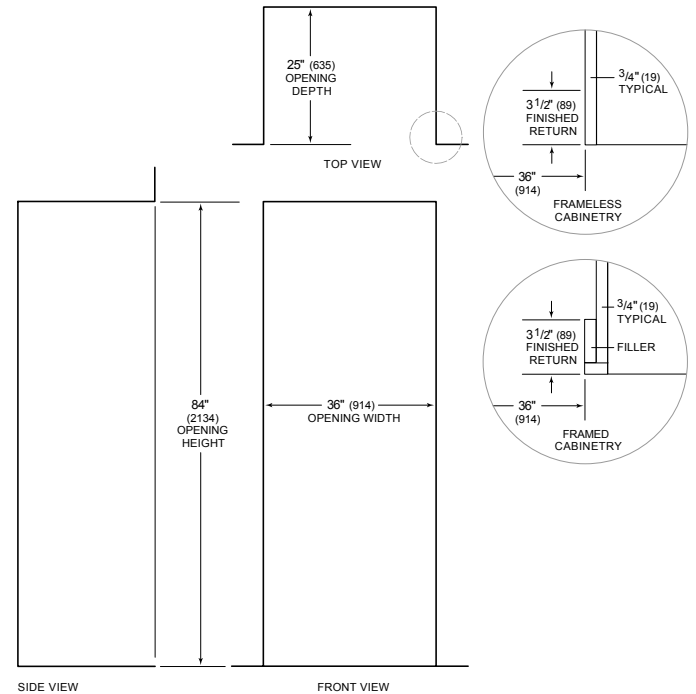

**NOTE:** 3 1/2" (89) finished returns will be visible and should be finished to match cabinetry