

40 SERIES DBI664IXXLSSOF



FEATURES

 Water softener

 Premium height-adjustable upper rack and premium lower rack

 Top tray with Instant Lift™

 Heavy-duty stainless steel construction

 Nylon-coated steel racks

 TouchProof™ stainless steel

 Turbo Drying™ system

 16 place-setting capacity

 Quiet operation—42 dB(A)

 9Spray™ wash system

 Hidden controls

 LED lit interior

 LED display

 Delayed start

PROGRAMS

- Normal Wash
- Eco Wash
- Sanitation Wash
- Time Program
- Plastic Wash
- Hygiene Wash
- Crystal Glass
- Lower Half Wash
- Upper Half Wash
- Self-Cleaning
- Rinse and Hold

PRODUCT SPECIFICATIONS

Model	DBI664IXLSSOF
Width	23 ⁷ / ₈ "
Height	34" – 35 ³ / ₄ "
Depth	22"
Door Clearance	24 ⁵ / ₈ "
Weight	115 lb
Electrical Supply	115 VAC, 60 Hz
Service	15 amp dedicated circuit
Receptacle	3-prong grounding-type
Power Cord	4'
Water Connection	6" PEX tubing with 3/8" NPT female connection
Drain Connection	5' corrugated tubing
Pressure	4.2–140 psi

Electrical supply, plumbing supply, and drain should be located in an adjacent cabinet. If not, they must be located within the shaded area shown in the illustrations below.

ELECTRICAL | PLUMBING

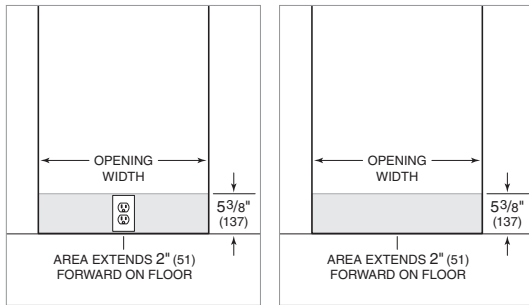

DIMENSIONS

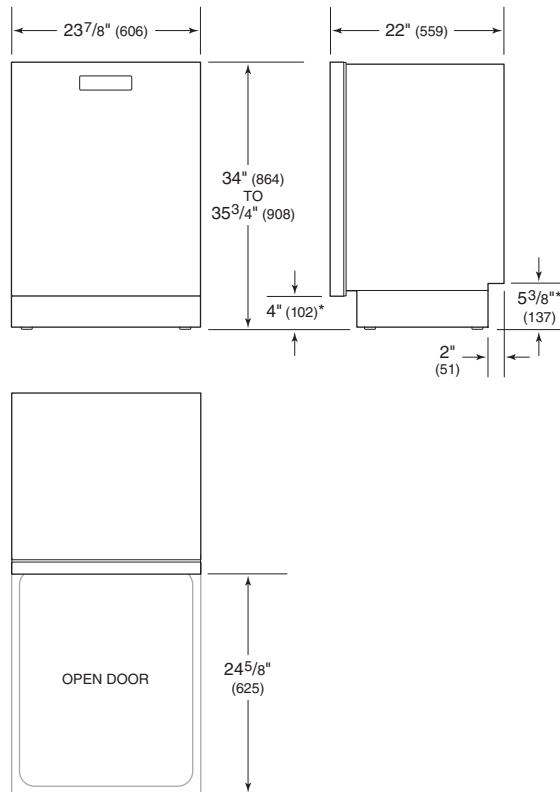

*Dimension will vary with product height.

INSTALLATION

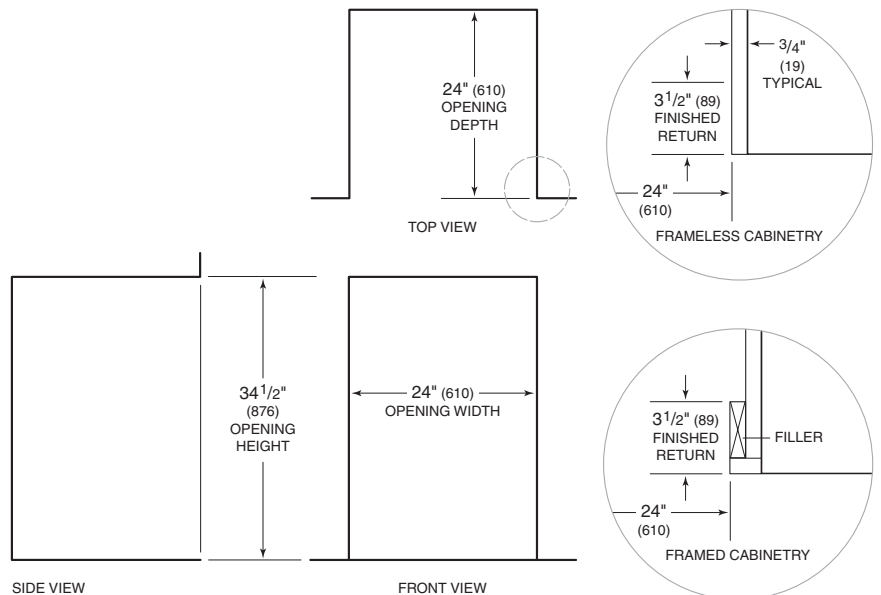

NOTE: 3¹/₂" (89) finished returns will be visible and should be finished to match cabinetry.