

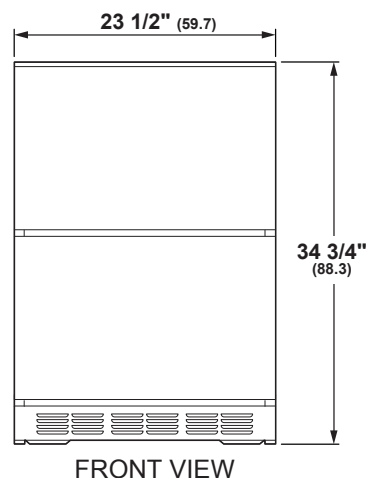

OVERALL DIMENSIONS

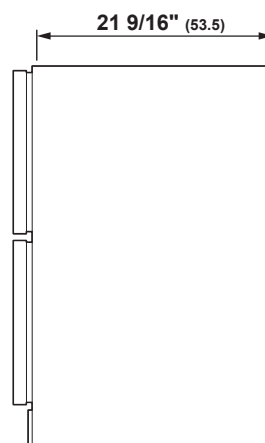

FRONT VIEW



SIDE VIEW

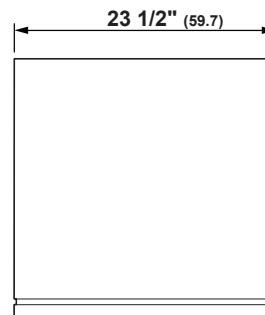

TOP VIEW

Dimensions in parentheses are in centimeters unless otherwise noted.

Actual product dimension may vary due to manufacturing tolerances.

SPECIFICATIONS

Overall Width	23 1/2" (59.7 cm)
Overall Height	34 3/4" (88.3 cm)
Overall Depth	23 1/4" (59.1 cm)
Overall Capacity	5.0 cu. ft.
Minimum Cabinet Width	23 3/4" (60.3 cm)
Minimum Cabinet Depth	24" (61.0 cm)
Cutout Width	23 3/4" (60.3 cm)
Cutout Height	34 1/2" (87.6 cm) Min 35" (88.9 cm) Max
Electrical Requirements	1.2 A
Voltz/Hertz/Amps	120 V, 60 Hz, 15 or 20 amp circuit
Shipping Weight	126 lb (57 kg)

ATTENTION ELECTRICIAN:

A 115 volt 60Hz., 15 or 20 amp power supply is required. An individual properly grounded branch circuit or circuit breaker is recommended. Install a properly grounded 3-prong electrical receptacle recessed into the back wall.



INSTALLATION

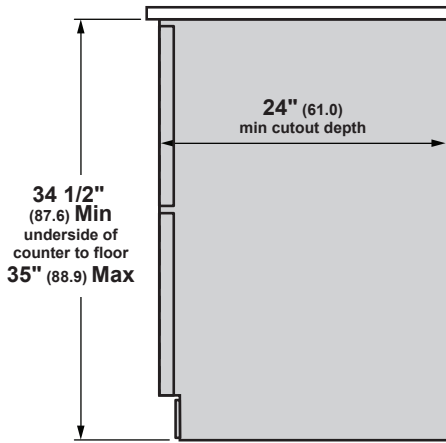

FLUSH CUTOUT INSTALLATION  
SIDE VIEW

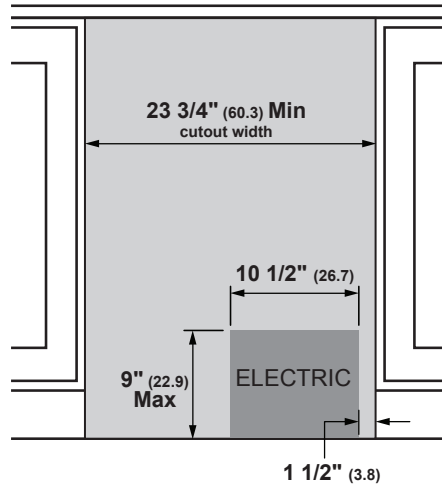

INSTALLATION CUTOUT  
FRONT VIEW

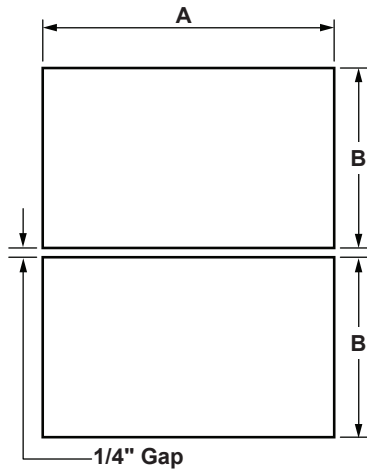

CUSTOM PANELS

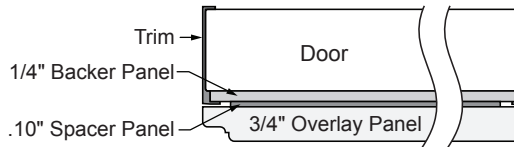

3/4" OVERLAY PANEL DIMENSIONS  
(IN INCHES)

	A (WIDTH)	B (HEIGHT)
1/4" Backer	23 3/16"	14 11/16"
.10" Spacer	22 1/2"	14 3/16"
3/4" Overlay	23 5/8"	15 1/16"

Note: Max assembled drawer panel wight is 25 lbs.  
 IMPORTANT: Maintain a 1/4" gap between the panels when installed.

NOTES

Model can be installed flush with standard cabinetry.  
 Designed to be built-in only. Cannot be used free-standing.  
 Black vented toekick with optional stainless steel toekick supplied.

## FEATURES AND BENEFITS

### DIGITAL TOUCH CONTROLS

Offer a range of temperatures for precise chilling of a variety of fresh foods and beverages, and a LED display allows easy viewing of temperatures

### FULL-EXTENSION SLIDE-OUT REFRIGERATED DRAWERS

Storage for everything from whole melons to 146 12-oz. cans

### SPACIOUS INTERIOR WITH ADJUSTABLE DIVIDERS, FOLD-DOWN SHELF AND REMOVABLE DRAWER BIN

Maximizes useable storage space and flexibility

### SOFT INTERIOR LED LIGHTING

Automatically illuminates when the door is open, but can be activated by an internal on/off switch

### FLUSH INSTALLATION

Allows near-seamless integration with surrounding cabinetry

### REVERSIBLE DOOR SWING

Easily reversed to left or right door swing as needed

### CUSTOM-PANEL READY

Lets you coordinate models within cabinetry for a look of elegant understatement. Customer must choose a custom door panel and handle to complement their decor

