

# MONOGRAM 27" BUILT-IN SINGLE OVEN

ZKS90DSSNSS



## THE MONOGRAM MINIMALIST COLLECTION

Streamlined design and precisely machined metals create a contemporary yet functional aesthetic

### LCD CONTROLS

Allow you to adjust oven settings with little effort

### WIFI CONNECT

Perfectly in sync with a busy lifestyle, Alexa or Google Home can be used to control an array of oven functions from both inside and outside the home

### SCAN-TO-COOK

Innovative and time saving, scan-to-cook technology ensures that packaged foods are always prepared correctly. A simple scan of the barcode with a smartphone delivers consistently, delicious results

### NO-PREHEAT AIR FRY

A must-have for health-conscious cooks, the No-Preheat Air Fry mode crisps food to crunchy perfection, without using oils or butter

### TRUE EUROPEAN CONVECTION

Achieve delicious results from a third heating element and fan combination

### 4.3 CUBIC FOOT CAPACITY

Accommodates even the largest meals

### EXCLUSIVE SELF-CLEAN (3 REGULAR) OVEN RACKS

Glide in and out smoothly on stainless steel ball bearings, and are designed to be left in the oven during the self-clean cycle

### TEN-PASS BAKE ELEMENT

Covers more surface area for more even baking results

### EIGHT-PASS BROIL ELEMENT

Provides complete coverage and even browning, even for large dishes

### SOFT-CLOSE DOOR

An expertly engineered hinge ensures that the oven door closes quietly and smoothly, every time

### SELF-CLEAN WITH STEAM CLEAN OPTION

Gives you flexible options for thorough oven cleaning

## WALL INSTALLATION

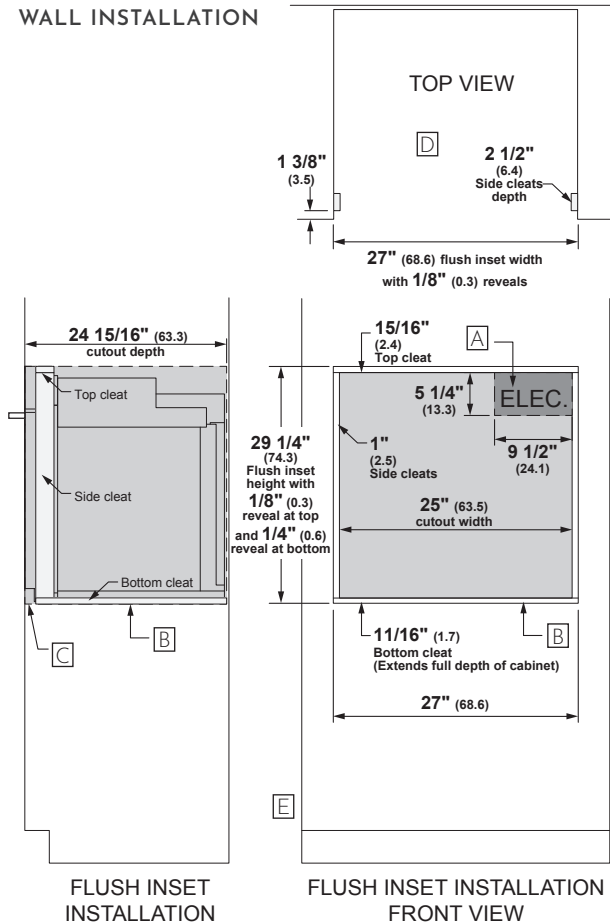

Allow 1/8" (0.3) clearances from side edges of oven door.

## UNDERCOUNTER INSTALLATION

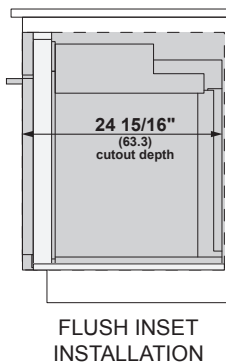

For more details, refer to the installation instructions for this product on [Monogram.com](http://Monogram.com). Dimensions in parentheses are in centimeters unless otherwise noted.

## HELPFUL TIPS

- A** Junction box location (May also be located in adjacent cabinet.)
- B** Platform must be able to support 220 lbs (99 kg)
- C** Cabinet surfaces must be an appearance finished surface for flush installation.
- D** Cleats may be visible and should be finished to match cabinetry.
- E** If using optional flush install vent trim accessory ZX27VT1, please adjust cutout height to 28-13/16" and bottom cleat height to 1/4".